

AIR BREATHING EQUIPMENT

These systems are available as a complete respiratory protection system for paint spraying or industrial applications.

All these systems are fully CE approved and offer the ultimate in comfort and protection although they have still been designed to provide easy spare parts replacement when necessary.

WARNING - The filters DO NOT remove carbon monoxide or other toxic gases. For air quality consult BS4275 1997. Please monitor and maintain a protective programme in accordance with the statutory regulations.

BAKIT 1 (A+B+C)

- Complete kit featuring the VIZ4 mask containing all required equipment for user's first system
- All components can be purchased separately
- Kit consists of:
 - VIZ4 (A)** - Full face mask with waist belt, regulator and activated carbon filter
 - KBH10516 (B)** - 10m & 1.5m pack of breathing hose Complete with required euro high flow couplings, adaptors and twin couplings
 - 34203425 (C)** - Coalescing filter 1/2"

Now available:
Crusader Air Fed
Visor, click here for
more information.



VIZ4 - Full Face Mask (A)

- Acetate high quality visor to BS.EN270 approved (formally TM14/7.45 Issue 7) APF40 Impact EN166.F
- Includes comfortable waist belt assembly consisting of regulator, carbon filter and flow indicator
- Light, comfortable, with easily adjustable headstraps, can be worn for long periods without problems
- Hoses positioned not to pull when in use
- Dismantles easily for cleaning, disinfecting and easy replacement of spare parts
- Air supply is through a waist belt with factory pre-set regulator to provide a safe flow of air when the inlet pressure is a minimum of 60 psi (4 bar)
- Flow indicator to waist belt carbon filter to indicate airflow, leakage, contamination to filter and blockage of the hose to the mask
- Belt fitted with active carbon filter to remove paint, thinner, oil vapours and odours
- Filter cartridge to be replaced when user detects odour breathe through, or every 400 hours of operation (typically every 2 months)
- White indicator pad in the filter shows red when bulk oil contamination

KBH10516 - Breathing Hose Pack (B)

- Complete hose kit
- Includes 10 metre supply hose (1/2" BSPT male supply)
- All required quick release high flow couplings included, with Y piece
- 1.5 metre hose to spray gun (1/4" bsp female)

34203425 - Coalescing Filter 1/2" (C)

- Contaminated air enters and passes inside the filter element water and oil are coalesced into larger droplets which are held in the outer drainage layer until drained by gravity
- All solid rust and dust particles are trapped within the pleated glass micro filter medium
- The medium is water repellent due to impregnation thus the filters will operate at a much lower pressure drop
- The filter will remove particles down to 0.01 micron and oil mist
- Now fitted with bowl guard as standard

VIZ4 - Spare Parts and Components

- 2114129 Acetate screen, head assembly & air tubes
- 2215089 Face skirt
- 0305119 Sweat band brow
- VC10PK Peel-off covers (pkt of 10)
- 2115079 Acetate screen
- RFI136 Waist belt assembly
- 97800145 Bowl for waist belt filter
- 26PC2646 Carbon element for waist belt filter
- MR120814 Push in connector (to visor from waist belt)
- GU26200014 Inlet connector
- 996W20C001G Flow indicator
- MP320018 Seal washer for flow indicator



BAKIT2 – Full Face Mask & Waist Belt Assembly (B + C + D)

- Complete kit featuring the Kolibri mask containing all required equipment for user's first system
- All components can be purchased separately
- Kit consists of:
 - KOLIBRI (D) - Full face mask with waist belt, regulator and activated carbon filter
 - KBH10516 (B) - 10m & 1.5m pack of breathing hose with required euro high flow couplings
 - 34203425 (C) - Coalescing filter 1/2"

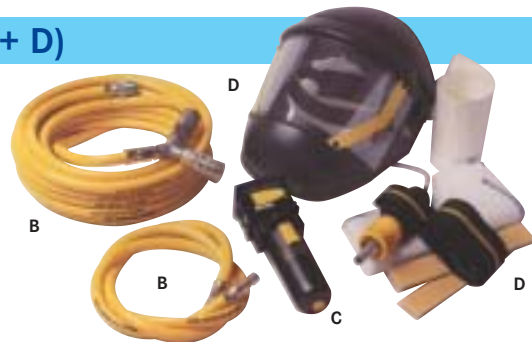

KOLIBRI – Full Face Mask & Waist Belt Assembly (D)

- Modern and aesthetically designed full face airfed spray helmet
- Manufactured from Thermoplastic to offer a strong, lightweight helmet for greater operator comfort
- Concentrates vision of operator onto work area – reducing light reflections etc.
- Fully washable face and head seal, easily removed and replaced offering increased operator comfort. Disposable Visors System allowing removal during operation
- Replaceable sweatbands
- Quick release adjustable belt
- Extremely cost effective
- CE approved
- EN 1835
- Class LDH2

Inline Airflow Regulator & Filter

Features

- Slim and low profile:
- Built-in activated carbon filter:
- Precise flow adjustment:
- Friction flow control:
- Modern design:
- In-line adjustment:

Benefits

- no catching
- operator safety
- wearer comfort
- simple operation
- operator acceptance
- no unintended readjustment

Kit consists of:

- Kolibri full face mask
- In-line regulator and activated carbon filter mounted on waist belt
- Two spare sweatbands (part number: 161472)
- Ten spare peel off covers (part number: 160730 supplied in a pack of 100)
- Three disposable hoods (part number: 160251)

KBH10516 – Breathing Hose Pack (B)

- Complete hose kit Includes 10 metre supply hose (1/2" BSPT male supply)
- All required quick release high flow couplings included, with Y piece
- 1.5 metre hose to spray gun (1/4" bsp female)

34203425 – Coalescing Filter 1/2" (C)

- Contaminated air enters and passes inside the filter element, water and oil are coalesced into larger droplets which are held in the outer drainage layer until drained by gravity
- All solid rust and dust particles are trapped within the pleated glass micro filter medium
- The medium is water repellent due to impregnation thus the filters will operate at a much lower pressure drop
- The filter will remove particles down to 0.01 micron and oil mist
- Now fitted with bowl and guard as standard

Spare parts			
Part No.	Drawing No.	Description	Quantity/ pack
160730	1	Disposable visor covers	100
160741	2	Acetate visor	1
160666	3	Clamps for visor covers	1 pair
160137	4	Face seal	1
160211	6	Head band	1
161310	9	Hose 6mm with silencer	1
160674	10	In-line regulator, hose nipple & air inlet nipple without filter	1
160147	11	Silencer for in-line regulator	1
160048	11a	Activated Carbon Filter	1
AA7102	12	Air inlet nipple	1
160693	13	Waist belt	1
161472	14	Sweat band	10
160251	15	Disposable hood	10

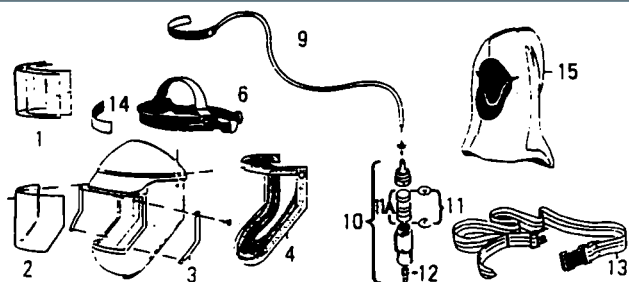

HM1 – Half Mask & Waist Belt Assembly

- Compact and comfortable half mask system to protect the nose and mouth area
- Includes adjustable waist belt assembly consisting of regulator, carbon filter and flow indicator
- Hoses positioned not to pull when in use
- Dismantles easily for cleaning, disinfecting and easy replacement of spare parts
- Air supply is through a waist belt with factory pre-set regulator to provide a safe flow of air when the inlet pressure is a minimum of 60 psi (4bar)
- Flow indicator to waist belt carbon filter to indicate airflow, leakage, contamination to filter and blockage of the hose to the mask
- Belt fitted with active carbon filter to remove paint, thinner, oil vapours and odours
- Filter cartridge to be replaced when user detects odour breathe through, or every 400 hours of operation (typically every 2 months)
- White indicator pad in the filter shows red when bulk oil contamination



TBS2 – Three Stage Breathing Air Set

- To provide quality breathing air to BS4275
 - The TBS2 is staged as below (all of these can be ordered separately)
- 34203003 – Pre filter 1/2" (Stage 1)**
- The fitted 5 micron element will extend the service of the coalescing filter (stage 2)
 - Fitted with bowl guard as standard

34203425 – Coalescing filter 1/2" (Stage 2)

- Contaminated air enters and passes inside the filter element, water and oil are coalesced into larger droplets which are held in the outer drainage layer until drained by gravity
- All solid rust and dust particles are trapped within the pleated glass micro filter medium
- The medium is water repellent due to impregnation thus the filters will operate at a much lower pressure drop
- The filter will remove particles down to 0.01 micron and oil mist
- Now fitted with bowl and guard as standard

34263006 – Activated Carbon Filter 1/2" (Stage 3)

- For removal of paint, thinners, oil vapours and odours
- Fitted with bowl guard as standard
- 34303003 Mounting bracket two per set

Safety Warning

The TBS2 or any of its individual components will not remove carbon monoxide or other toxic gases

Specifications

- Port Size: 1/2" bsp
 - Max. Airflow: 28cfm (792ltr/min)
 - Max Pressure: 150psi (10.3 bar)
- 97801731 Element for pre-filter (34203003)
 - 6342061 Element for coalescing filter (34203425)
 - 26PC39112 Element for carbon filter (34263006)
 - 97801838 Polycarbonate bowl and guard for 34203003 and 34203425
 - 97801778 Polycarbonate bowl and guard for 34263006
 - 34203054 *Regulator 1/2"
 - PG20 Pressure gauge 0 -160psi, 1/8" bsp, back entry

*Note: HC6898 union and PG20 gauge also required to connect regulator to TBS2



34203054