

The NPK One Punch Hammer is a unique device for removing efficiently adhesive powder which is in the shape of bridges and rat holes adhered to the inside of storage tanks, hoppers and chutes by making use of strong piston impact operated by compressed air. Impact energy can be optionally selected by adjusting compressed air pressure.

FEATURES

- Lubrication free type
- Low noise and lower air consumption because of one-punch system.
- Accurate impacting intervals can be optionally obtained by controller.



OPH-30



OPH-40



OPH-60



OPH-80

Sequential Controller: Off Time: 0.2~10min. On Time: 0.3~1.5sec.

Model No. SC-01-0-100. AC100/110V, 50/60Hz

Model No. SC-01-0-200. AC200/220V, 50/60Hz

Solenoid Valve

Model No. JKF-130-804-1-AC100V. AC100/110V, 50/60Hz, Rc¹/₄

Model No. JKF-130-804-1-AC200V. AC200/220V, 50/60Hz, Rc¹/₄

Manual Valve: Push Type

Model No. 250, Rc¹/₄

SPECIFICATIONS

Model No.	Impact Energy			Net Weight Approx.		Average Air Consumption		Recommend Air Pressure		
	J	kgf · m	ft · lb	kg	lb	l/time	ft ³ /time	MPa	kg/cm ²	psi
OPH-30	4.1~12.5	0.42~1.27	3.03~9.1	1.7	3.7	0.8	0.03	0.2~0.6	2-6	28-85
OPH-40	14.8~44.3	1.51~4.53	10.9~32.7	3.0	6.6	1.0	0.04	0.2~0.6	2-6	28-85
OPH-60	54~108	5.51~11.0	39.8~80	6.6	14.5	1.5	0.05	0.3~0.6	3-6	43-85
OPH-80	94.6~189	9.65~19.3	69.8~140	11.8	26	2.0	0.07	0.3~0.6	3-6	43-85

Specifications are subject to change without notice.

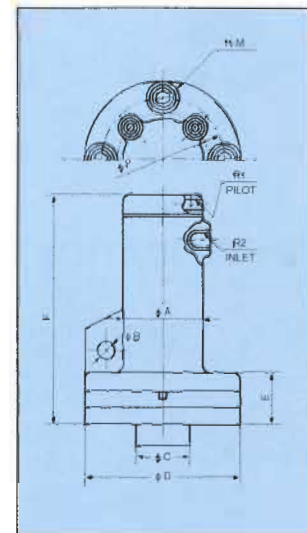

DEMENSIONS

Model No.	φA		φB		φC		φD		E		F		φP		N-M	R ₁	R ₂
	mm	in	mm	in	mm	in	mm	in	mm	in	mm	in	mm	in	mm	Rc	Rc
OPH-30	38	1 1/2	12	15/32	27.2	3/4B	85	3 11/32	28	1 3/32	132.5	5 7/32	65	2 9/16	4-M10	1/8	1/8
OPH-40	50	1 31/32	12	15/32	48.6	1 1/2B	95	3 3/4	33.5	1 5/16	172.5	6 9/32	75	2 15/16	4-M10	1/8	1/8
OPH-60	70	2 3/4	20	25/32	76.3	2 1/2B	130	5 1/8	42.5	1 11/16	204.5	8 1/16	105	4 1/8	4-M12	1/8	1/4
OPH-80	90	3 17/32	20	25/32	89.1	3B	155	6 3/32	46	1 13/16	232.5	9 5/32	130	5 1/8	4-M12	1/8	1/4

Specifications are subject to change without notice.